

CITY OF SAN PABLO
CONTRA COST COUNTY, CALIFORNIA

SAN PABLO AVE AND CHURCH LANE SIDEWALK, CURB AND GUTTER REPAIR

CONTRA COSTA COUNTY
CALIFORNIA

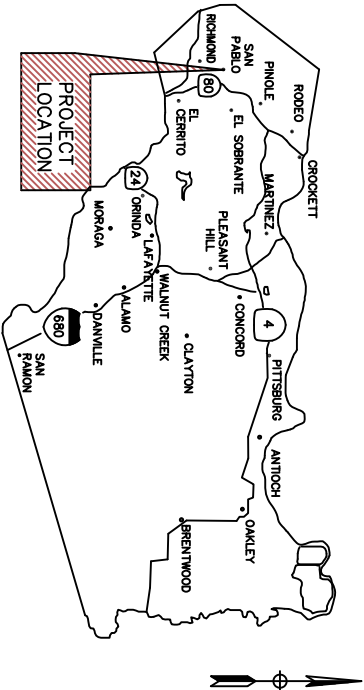

LOCATION MAP
NO SCALE



NOTE:
ALL EXISTING UTILITIES MAY NOT BE
PLOTTED ON THESE PLANS.
CONTRACTOR TO VERIFY EXISTING
CONDITIONS PRIOR TO COMMENCEMENT
OF WORK.

LEGEND

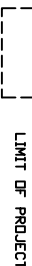

LIMIT OF PROJECT



REMOVE AND REPLACE CONCRETE
CURB, GUTTER OR SIDEWALK

ABBREVIATIONS

AB AGGREGATE BASE
AC ASPHALT CONCRETE
APPROX APPROXIMATE
BSW BACK OF SIDEWALK
CL CENTERLINE
C&G CURB AND GUTTER
CONT. CONTINUOUS
DWG DRAWING
EB DRIVEWAY
EL OR ELEV ELEVATION
EXST. EX EXISTING
FH FIRE HYDRANT
FOG FACE OF CURB
GTR GUTTER
HORIZ HORIZONTAL
IN INCH

LF LINEAR FOOT
MAX MAXIMUM
MIN MINIMUM
MON MONUMENT
PORTLAND CEMENT CONCRETE
PT POINT OF JANGENCY
SANITARY SEWER CLEANOUT
SS STANDARD
STD SIDEWALK
SW TELEPHONE BOX
TSB TRAFFIC SIGNAL BOX
TYP TYPICAL
W/ WITH
WM WATER METER
WV WATER VALVE

CONSTRUCTION NOTES:

1. REMOVE AND REPLACE EXISTING SIDEWALK CURB AND GUTTER AS MARKED IN THE FIELD TO MATCH EXISTING AND PER CITY OF SAN PABLO STANDARD SA-03. LENGTH OF CURB AND GUTTER AND AREA OF SIDEWALK ARE INDICATED ON PLANS. (DWY) INDICATES THAT CURB ADJUT'S DRIVEWAY AND MUST CONFORM TO THE DRIVEWAY PAN.
REMOVE AND REPLACE DRIVEWAY AS MARKED IN THE FIELD PER CITY OF SAN PABLO STANDARD SA-01 OR SA-02. AREA OF REPLACEMENT IS INDICATED ON PLANS.
2. SLOPE AND DIMENSION TO MATCH EXISTING DR AS SPECIFY ON PLAN

QUANTITY:
Remove and replace sidewalk total of 2500 sf
Remove and replace curb and gutter 75 lf

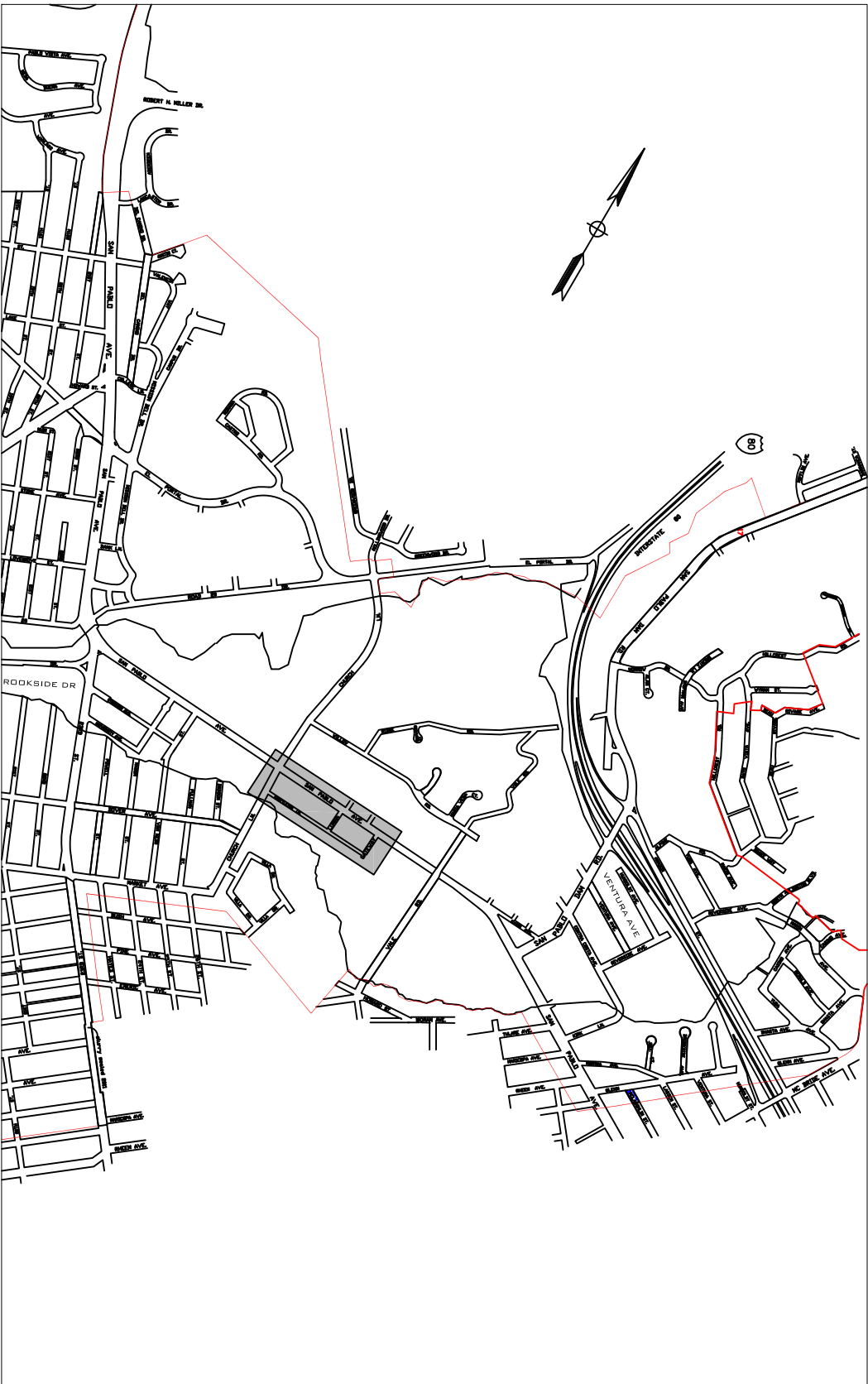

EXISTING FACILITIES TO BE PROTECTED.

VICINITY MAP
NO SCALE

- EXISTING FACILITIES TO BE PROTECTED.
- ▲ MONUMENT
 - SANITARY CLEANOUT
 - SANITARY SEWER MANHOLE
 - HAND HOLE
 - STORM DRAIN MANHOLE
 - GAS VALVE
 - WATER VALVE
 - UTILITY (GAS MARKED)
 - D DRAINAGE INLET
 - FIRE HYDRANT
 - CABLE BOX
 - ELECTRICAL BOX
 - STREET LIGHT BOX
 - TELEPHONE BOX
 - TRAFFIC SIGNAL BOX
 - UNKNOWN UTILITY BOX

BARBARA HAWKINS, CITY ENGINEER
R.C.E. No. 12345 EXPIRES 12/31/15
CITY OF SAN PABLO



DATE

THESE DRAWINGS AND SPECIFICATIONS ARE THE PROPERTY
AND COPYRIGHT OF THE ENGINEER AND SHALL NOT BE USED OR
REPRODUCED IN ANY MANNER WITHOUT THE WRITTEN
CONSENT OF THE ENGINEER. ENGINEERS SHALL HAVE PRESENCE OVER
ON THE JOB SITE. ANY DISCREPANCY SHALL BE BROUGHT TO THE
NOTICE OF THE ENGINEER PRIOR TO THE START OF ANY WORK.

DRAWN BY _____ LECK S
CHECKED BY _____
APPROVED BY _____ BARBARA H

DATE ISSUED MAY 2, 2017
JOB NO. _____
PW 000

CITY OF SAN PABLO
ONE ALVARADO SQUARE
SAN PABLO, CA 94806
(510) 215-3030 FAX 215-3031

CITY OF SAN PABLO
SIDEWALK, CURB AND GUTTER REPAIR
PROJECT

TITLE
SHEET

SHEET 1 OF 2

EXISTING SIDEWALK, CURB
AND GUTTER TO REMOVE
AND REPLACE. CITY
REPRESENTATIVE TO FIELD
MARK AREAS PRIOR TO
CONSTRUCTION

EXISTING STREET
TREES TO REMAIN

SAN PABLO

AVE

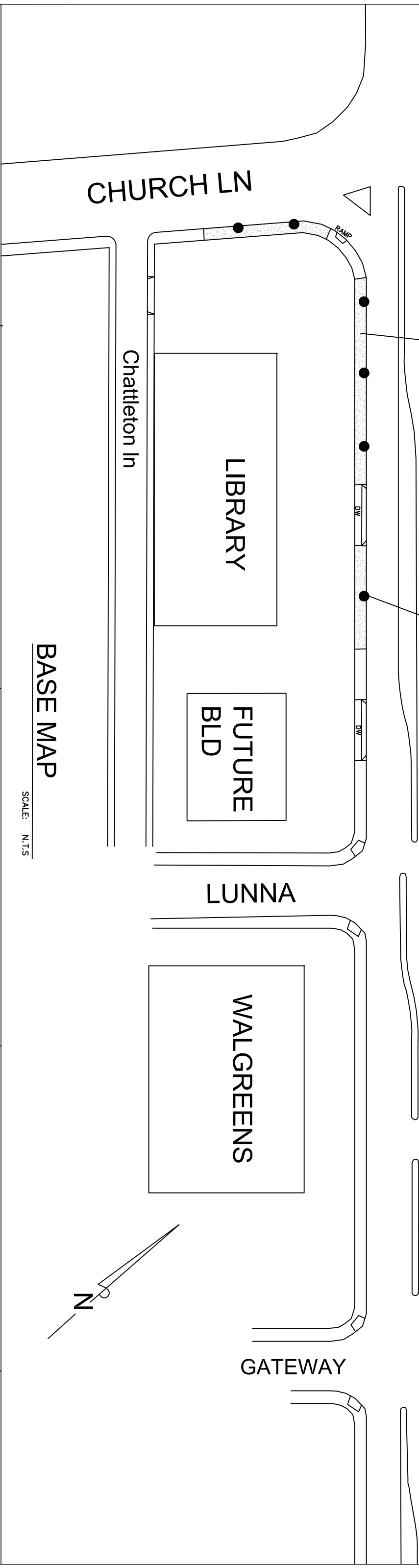

BASE MAP

SCALE: N.T.S

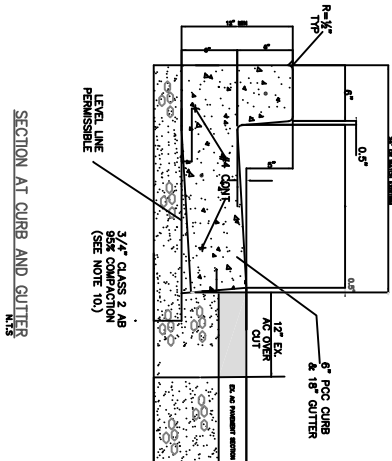

STEEL REINFORCEMENT DETAIL

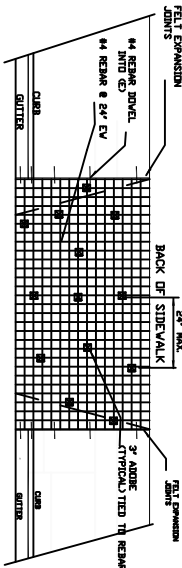

SECTION AT DRIVEWAY
NTS

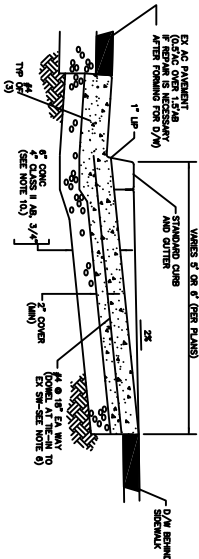

SECTION AT SIDEWALK
N.T.S

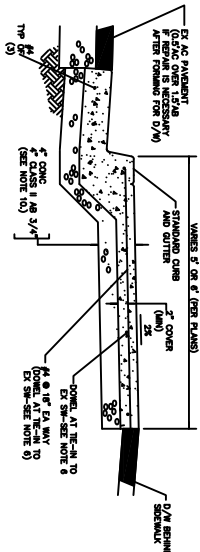

PLAN VIEW TYPE A
M.T.S

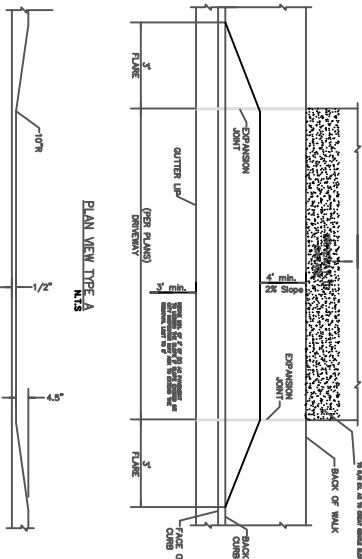

SCORE LINE DETAIL

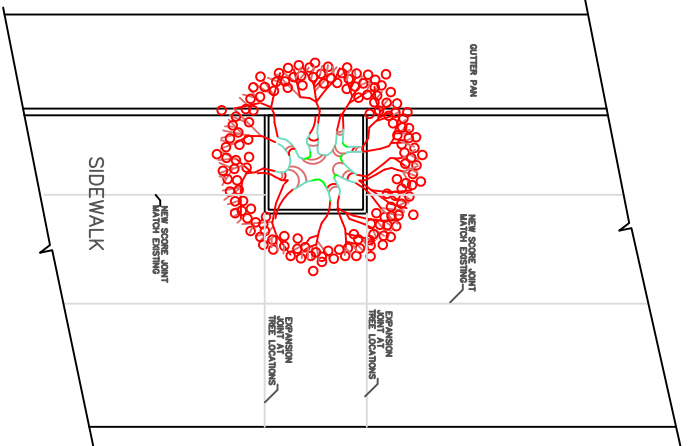

BARBARA HAWKINS, CITY ENGINEER
R.C.E. No. 12345 EXPIRES 12/31/15
CITY OF SAN PABLO

[illegible]